

# WATERPROOF AND PROTECT YOUR FOUNDATION WITH EXPERT SOLUTIONS

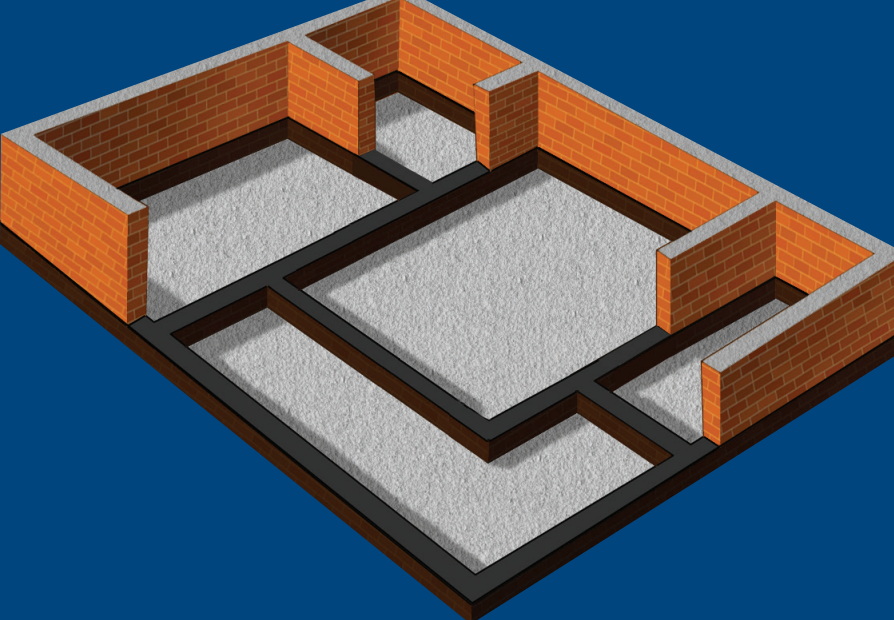

## THE RIGHT SOLUTION

**Complete waterproofing & Protect your Foundation**

=



**Strength**

+



**Protection**

## THE RIGHT METHOD TO LAY THE FOUNDATION

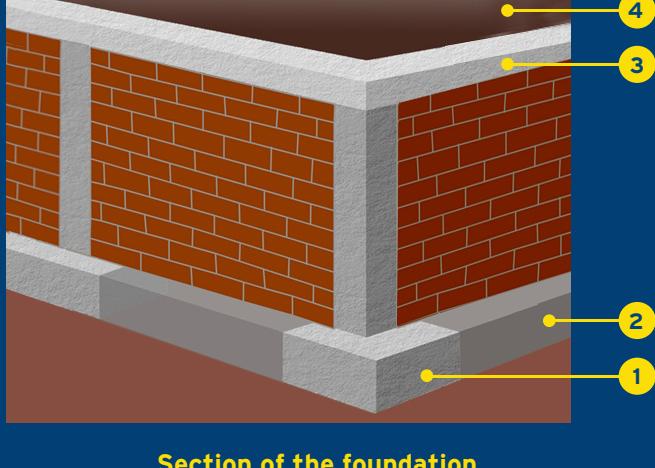

**Section of the foundation**

- 1 Lay the Footing and PCC**  
Lay the Footing and PCC beam with concrete. The concrete used should be strengthened by Dr. Fixit LW+. For details of LW+ usage, refer 'How to Apply' section below.
- 2 Dr. Fixit Bitufix on Footing and PCC**  
Protect the footing and the PCC with Dr. Fixit Bitufix. Ensure the curing of concrete is done properly before application and in SSD condition. For details of Bitufix usage, refer 'How to Apply' section below.
- 3 Brickwork and Plinth**  
Lay the brick work and rise till the Plinth beam. Use Dr. Fixit LW+ in the mortar while brickwork.
- 4 Dr. Fixit Bitufix**  
Apply Dr. Fixit Bitufix on the plinth beam and 2 layers of brick to completely waterproof the foundation.
- 5 Backfilling**  
After the application is completed do the backfilling of the foundation.

## BENEFITS OF WATERPROOFING WITH US



Increases the strength of the structure



Increases cohesion of the concrete



Protects the steel bars from corrosion



Provides a protective coating and stops water from permeating



Resists the attack of salts present in the soil



Prevents rising water dampness

## HOW TO APPLY

### Dr. Fixit LW+



**1**

Prepare the concrete mixer by mixing cement and aggregates as per requirement



**2**

Add Dr. Fixit LW+ to water  
**Dosage:**  
**1 ltr Dr. Fixit LW+ for 5 bags of 50 kg Cement**

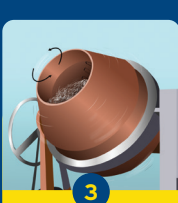

**3**

Now add this water to the concrete mixer and stir for 2 minutes



**4**

This strengthened concrete mortar is ready to be applied. Use it for motherslab and plastering of parapet walls.

**Available in** 200 ml, 1 ltr, 5 ltr, 10 ltr, 20 ltr and 50 ltr pack sizes.



### Dr. Fixit Bitufix



**1**

Two coats of Dr. Fixit Bitufix should be applied on the Footing, Masonry wall and Plinth beam



**2**

Cover the plinth beam with two layers of bricks. It should also be coated with two coats of Dr. Fixit Bitufix



**3**

After the completion of application of Dr. Fixit Bitufix, backfilling should be done  
**1 kg/m²/ 2 coats for 500 micron thickness**

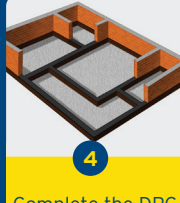

**4**

Complete the DPC course over the bricks, plinth beam, neck columns etc.

**Available in** 5 kg and 20 kg pack sizes.

Please contact your local Dr. Fixit dealer for latest prices.

## PRECAUTIONS

- Both products must be used together for complete protection and in right dosage for desired results.
- Please do not add Dr. Fixit LW+ directly to dry cement & aggregate mix.
- Proper curing of the concrete should be done and SSD condition before application of Dr. Fixit Bitufix.
- Backfilling should be done only after the curing of the product.
- Care must be taken not to damage the coating during backfilling.